

LIGHTMASTER 1000 E40 - CIRCULAR

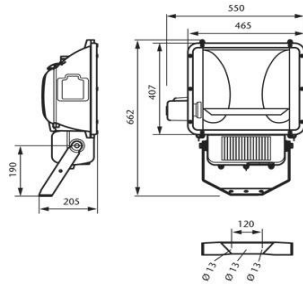

GENERAL SPECIFICATIONS

Type	Floodlight for big areas lighting
Applications	Big areas, airports, sport venues



FLOODLIGHT DATA

Gross weight	25,40 Kg
Volume	0.1377 m ³
Wind exposed surface - tilt 70°	0.2160 m ²

COMPATIBLE LAMPS

MT (JM-T) 1000W E40
ST (SAP-T) 1000W E40



TECHNICAL SPECIFICATIONS

Insulation class	CL I / CL II
Overall protection degree	IP66
Protection degree against external impacts	IK08
Certifications	CE / ENEC
Construction standards	EN 60598-1

POWER SUPPLY SPECIFICATIONS

· Porcelain E40 lampholder complete with anti-screwing out device.
· Gear housing separated from optical housing, complete of ignitor.
· The luminaire is also available in the version complete with incorporated control gear kit (only for insulation class I).
· The CABLO SERVICE box, in die-cast aluminium IP 65 for class I or in thermoplastic material IP 66 for class II, may be used for the supply of the lamp.

MATERIALS AND FITTINGS

Reflector	High purity aluminum (99.99%) with elevated reflectance.
Body, rear cover and glass frame	Die cast aluminum with primary alloy and low copper content with a high weather
Colour	Silver
Painting	Polyester powder
Mounting bracket	Hot dipped galvanized steel
Front glass	Tempered and resistant to high temperatures and to thermal shock.
Anti-vacuum device	Teflon
Gaskets	Anti-ageing, in silicon rubber
Protractor scale	Aluminium

OPTICAL SYSTEM	
Description	Paraboloid rotational optical system The flux reflecting skirt reduce considerably the direct glare, ensuring an improved visual comfort.
Suitable lamps	MT (JM-T) 1000W E40 ST (SAP-T) 1000W E40

PHOTOMETRIC DATA

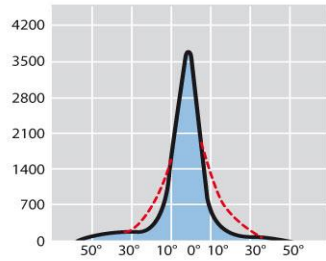

MT (JM-T) 1000W E40



LIGHTMASTER 1000 E40
Circular

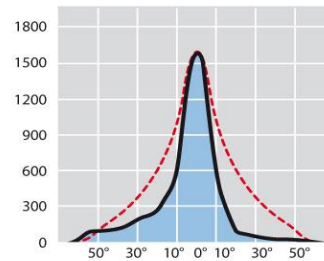

ST (SAP-T) 1000W E40



LIGHTMASTER 1000 E40
Circular

The Fael LUCE products are subject to constant evolution. Therefore, the values given in this document are subject to change.